

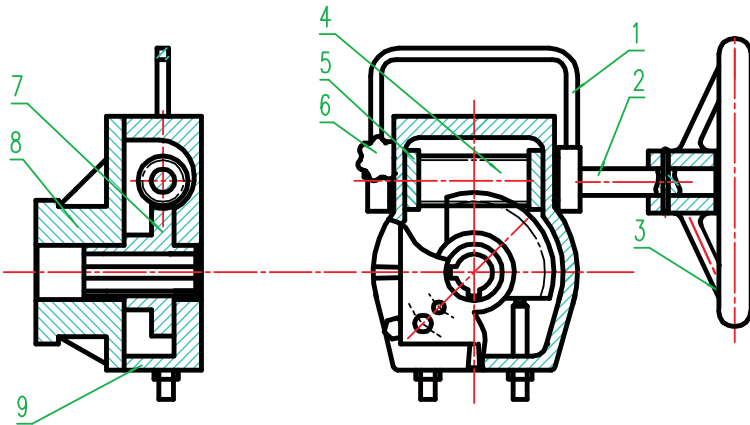

A280 Manual Override Gearboxes

A280 Manual override gearboxes are used on pneumatic actuated valves between valve and actuator for local emergency manual operation in case of air failure.

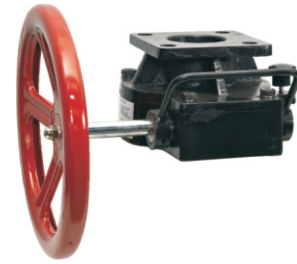

Material List

| No | Part Name | Materials |
|----|-------------------|--------------------------|
| 1 | Handle | Carbon Steel |
| 2 | Worm Shaft | Carbon Steel |
| 3 | Handwheel | Cast Iron / Carbon Steel |
| 4 | Worm | Ductile Iron |
| 5 | Off Centre Sleeve | Carbon Steel |
| 6 | Locking Screw | Carbon Steel |
| 7 | Worm Gear | Ductile Iron |
| 8 | Cap | Cast Iron / Carbon Steel |
| 9 | Body | Cast Iron / Carbon Steel |

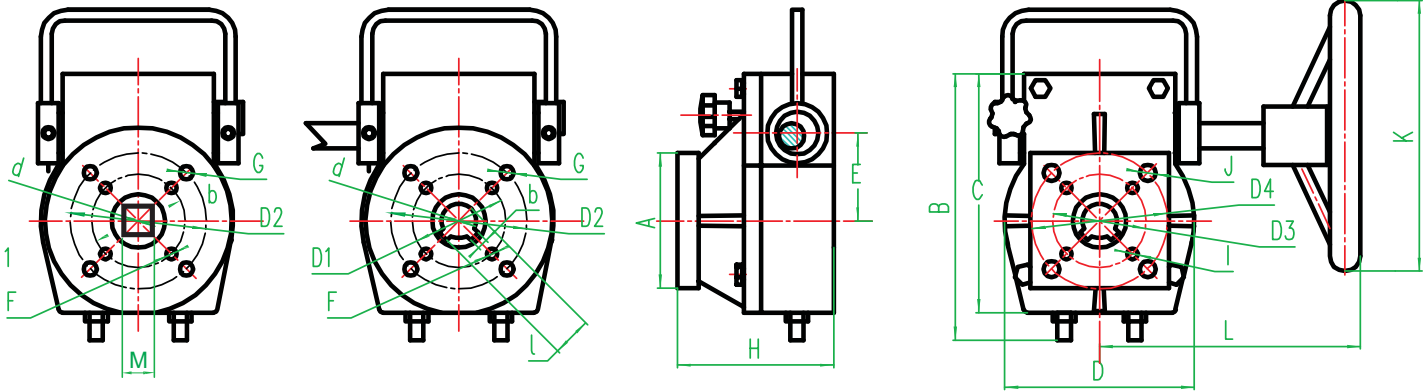

Dimensions (mm)

| Model | Gear Ratio | Torque Output (Nm) | M | d | b | t | D1 | F | D2 | G | A | H | E | D3 | I | D4 | J | K | L | B2 | C | D5 | Weight (Kg) | |
|-------|------------|--------------------|-------|-----|----|-------|-----|-----|-----|-----|-----|-----|------|-----|-----|-----|----|------|-------|-------|-----|------|-------------|--------|
| MOA-1 | 26:1 | 300 | 11/14 | 22 | 6 | 25,4 | | | 70 | M8 | 70 | 99 | 50,5 | | | 70 | Ø9 | Ø200 | 155 | 160 | 145 | 110 | 7,50 | |
| MOA-2 | 38:1 | 550 | 17/22 | 26 | 8 | 29,3 | 70 | M8 | | | 100 | | 117 | 65 | | | | Ø200 | 195 | 195 | 175 | 140 | 12,00 | |
| | | | | 38 | 10 | 41,3 | | | 102 | M10 | 110 | | | | | | | 102 | Ø12 | | | | | |
| MOA-3 | 54:1 | 1200 | 27/36 | 38 | 10 | 41,3 | 125 | M12 | | | | | | 125 | Ø14 | | | Ø300 | 205 | 235 | 215 | 180 | 17,00 | |
| | | | | 48 | 14 | 51,8 | | | 140 | M16 | | 130 | 118 | 85 | | | | 140 | Ø18 | | | | | |
| MOA-4 | 80:1 | 2000 | 36 | 48 | 14 | 51,8 | 140 | M16 | | | | | | 140 | Ø18 | | | Ø400 | 245 | 320 | 298 | 250 | 35,00 | |
| | | | | 60 | 18 | 64,4 | | | 165 | M20 | | | 156 | 148 | 124 | | | 165 | Ø22 | | | | | |
| MOA-5 | 78:1 | 3600 | 46 | 60 | 18 | 64,4 | 165 | M20 | | | | 220 | 150 | 142 | | | | Ø600 | 265 | 360 | 340 | 285 | 48,00 | |
| MOA-6 | 98:1 | 9000 | 46 | 80 | 18 | 84,4 | 165 | M20 | | | | 230 | 195 | 229 | 165 | Ø22 | | | Ø800 | 410 | 550 | 530 | 460 | 156,00 |
| MOA-7 | 100:1 | 13000 | 55 | 100 | 20 | 105,3 | 254 | M16 | | | | 300 | 195 | 258 | 254 | Ø18 | | | Ø800 | 430 | 605 | 585 | 520 | 190,00 |
| MOA-8 | 118:1 | 22100 | 75 | 120 | 32 | 129,3 | 356 | M30 | | | | 445 | 250 | 391 | 356 | Ø32 | | | Ø1000 | 550 | 900 | 870 | 800 | 540,00 |
| | | | | 180 | 45 | 196 | 483 | M36 | | | | 600 | 275 | 390 | 483 | Ø39 | | | | Ø1000 | 600 | 1050 | 900 | |