

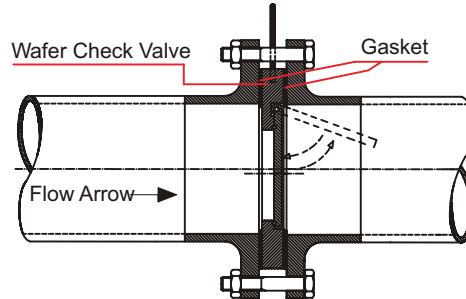

V701 Wafer Type Check Valves

Proval V701 Series wafer check valves are used to prevent the back flow in water lines, HVAC, marine and other industrial applications



Material List

| No | Part Name | Available Materials |
|----|-------------|---|
| 1 | Body | ASTM A105/AISI304/AISI316/AISI316L/Bronze |
| 2 | Disc | AISI316/AISI316L/Bronze |
| 3 | O-Ring Seal | EPDM/NBR/Viton/Silicon/PTFE/Bronze |
| 4 | Ear | AISI316 |
| 5 | Bolt | AISI316 |
| 6 | Hanger | Galvanized Steel |

A-A Section

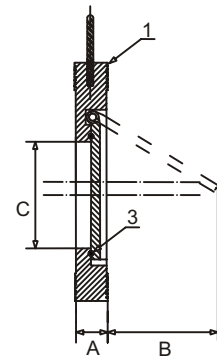

Dimensions (mm)

| Size (DN) | A | B | C | D | | | | | Weight (Kg) |
|-----------|----|-----|-----|-----|------|------|------|---------|-------------|
| | | | | PN6 | PN10 | PN16 | PN25 | ANSI150 | |
| 40 | 14 | 30 | 22 | 88 | 95 | 95 | 95 | 86 | 0,7 |
| 50 | 14 | 35 | 32 | 98 | 109 | 109 | 109 | 105 | 0,9 |
| 65 | 14 | 48 | 40 | 118 | 129 | 129 | 129 | 124 | 1,2 |
| 80 | 14 | 60 | 54 | 134 | 144 | 144 | 144 | 137 | 1,5 |
| 100 | 18 | 78 | 70 | 154 | 164 | 164 | 170 | 175 | 2,4 |
| 125 | 18 | 98 | 92 | 184 | 195 | 195 | 198 | 195 | 3,4 |
| 150 | 20 | 117 | 112 | 209 | 220 | 220 | 228 | 220 | 4,6 |
| 200 | 22 | 160 | 154 | 264 | 275 | 275 | 285 | 279 | 7,5 |
| 250 | 26 | 200 | 200 | 319 | 330 | 330 | 343 | 340 | 13,1 |
| 300 | 32 | 235 | 240 | 375 | 380 | 387 | 403 | 410 | 20,4 |
| 350 | 38 | 258 | 270 | 425 | 440 | 448 | 460 | 448 | 32,0 |
| 400 | 44 | 300 | 310 | 475 | 490 | 495 | 517 | 514 | 48,0 |
| 450 | 50 | 331 | 360 | 530 | 540 | 557 | 567 | 548 | 63,0 |
| 500 | 56 | 268 | 405 | 580 | 596 | 617 | 624 | 605 | 87,0 |
| 600 | 62 | 435 | 486 | 680 | 695 | 734 | 731 | 715 | 130,0 |

