

V702 Disco Type Check Valves

Proval V702 Series wafer check valves are used to prevent the back flow in water lines, HVAC, marine and other industrial applications.



Material List

No	Part Name	Materials			
1	Body	Brass	A216 WCB	AISI316	AISI316L
2	Disc	AISI304	AISI304	AISI316	AISI316L
3	Spring	AISI304	AISI304	AISI316	AISI316L

Body Materials According to Sizes

No	Size	Brass	A216 WCB	AISI316	AISI316L
1	DN15-100	•		•	•
2	DN125-DN200		•	•	•

Max Working Pressures (bar) According to Body Materials

No	Size	Brass	A216 WCB	AISI316	AISI316L
1	PN10/16	•	•	•	•
2	PN40			•	•

Dimensions (mm)

Size (DN)	15	20	25	32	40	50	65	80	100	125	150	200
A	16	19	22	28	32	40	46	50	60	90	106	140
ØD	40	47	56	72	82	95	115	132	152	193	222	288

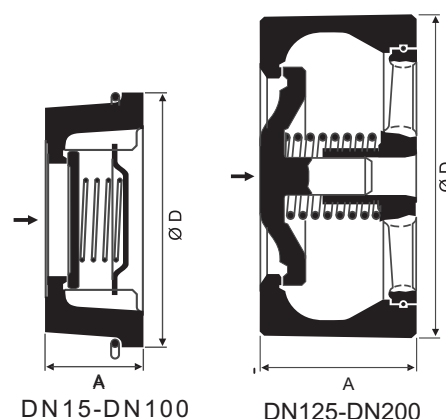

V704 Ball Check Valves

Proval V704 Series ball check valves are used in slurries to prevent the back flow.

Material List

No	Part Name	Material
1	Body	Epoxy Coated (DN20-DN100), GGG40 D.I (DN125-DN250)
2	Ball	DN20-DN40 Resine, DN50-DN100 Rubber Lined Aluminum
3	O-Ring Seal	EPDM/NBR
4	Cap	Epoxy Coated (DN20-DN100), GGG40 D.I (DN125-DN250)
5	Bolt	AISI316

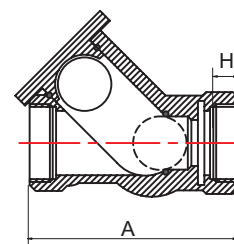
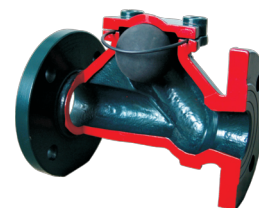

Threaded End Ball Check Valve

Threaded End Ball Check Valve Dimensions (mm)

Size (Inch)	1"	1-1/4"	1-1/2"	2"	2-1/2"
A	114	132	145	174	200
H	17	18	20	22	22
Weight (Kg)	1,5	2	2,6	3,8	6,1

Flanged End Ball Check Valve Dimensions (mm)

Size (DN)	20	25	40	50	65	80	100	125	150	200	250
A	117	127	159	200	210	260	300	350	400	500	670
ØD	PN10/16	105	115	150	165	185	200	220	250	285	395
	ASA 125/150	99	108	127	153	178	190	228	254	280	406
B	65	65	87	120	120	150	175	205	255	374	405
ØD	70	70	85	120	135	180	210	250	285	340	450
Weight (Kg)	5	5	8	10	15	20	25	40	63	85	156

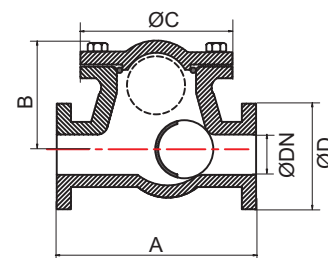

Flanged End Ball Check Valves